

PRESENTING THE WARDROBE PROGRAMME

SWING DOOR WARDROBE



HEIGHTS:	MODULES:
- 2256	- 425
- 2384	- 475
- 2544	- 575
- 2896	- 875
	- 975
	- 1175
	- Corner
	- End

PRESENTING THE WARDROBE PROGRAMME

COPLANAR SLIDING DOOR WARDROBE

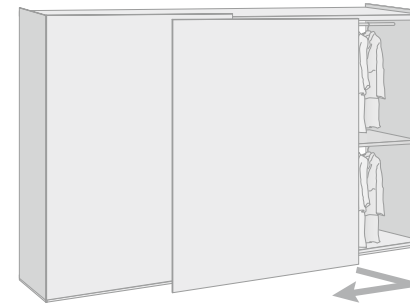

HEIGHTS:	MODULES:
- 2256	- 875 _1 door W. 909
- 2384	- 975 _1 door W. 1009
- 2544	- 1175 _1 door W. 1209
	- 1325 _1 door W. 1399
	- 1475 _1 door W. 1509

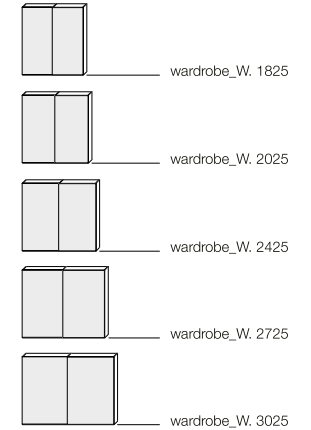

SLIDING DOOR WARDROBE

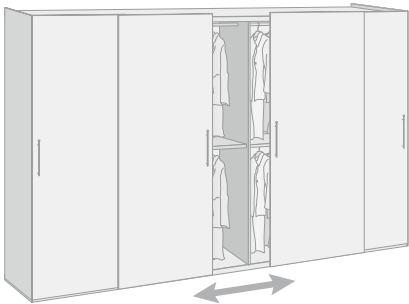

HEIGHTS:	MODULES:
- 2256	- 725 _1 door W. 770
- 2384	- 875 _1 door W. 920
- 2544	- 975 _1 door W. 1020
	- 1175 _1 door W. 1220
	- 1325 _1 door W. 1370
	- 1475 _1 door W. 1520
	- Corner

LISCIA_SWING DOOR

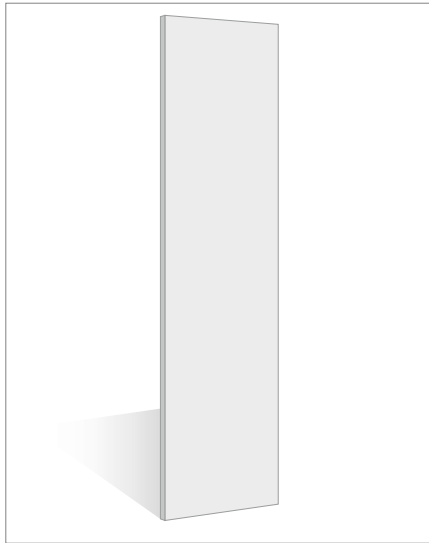
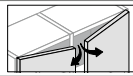

TECHNICAL FEATURES

The Liscia sliding door is composed of:
 – a 22 mm thick MDF panel with a low formaldehyde content for the matt and gloss lacquer finish.

CROSS-SECTION

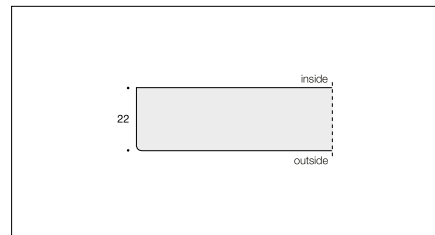

FRONTS

basic matt lacquer



matt palette lacquer



basic gloss lacquer



gloss palette lacquer



HANDLES (see page 49 - 50)

	SWING
Avant	•
Chiave Passpartout	•
Filo New L. 1120	•
Gea L. 140 orizzontale	•
Kono Ø 50	•
Lipsi	•
Concealed handle	•
Movida corta L. 260	•
Movida lunga L. 772	•
Push-to-open	o
Petra	•
Sagitta	•
Sky	•
Tecna corta L. 260	•
Tecna lunga L. 772	•

o = NOT AVAILABLE FOR H. 2877, CORNER, END AND OPENING SIDE DOORS

DOOR DIMENSIONS

DOOR TYPES	H. 2256	H. 2384	H. 2544	H. 2896
W. 450	•	•	•	•
W. 500	•	•	•	•
Swing W. 600	•	•	•	•

LISCIA COLOR WOOD_WOOD_SWING DOOR

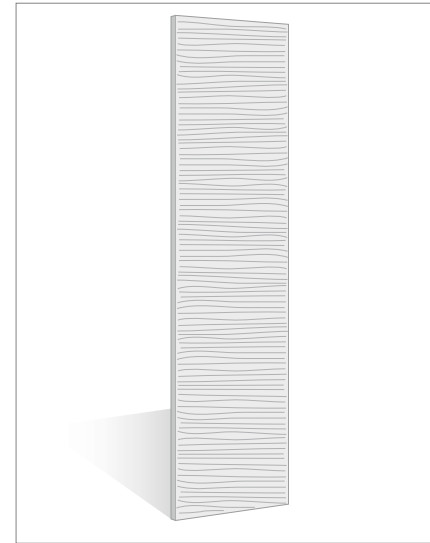
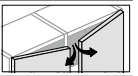

TECHNICAL FEATURES

The Liscia Color wood and wood veneer swing door is composed of:
 – a 26 mm thick particleboard panel with a low formaldehyde content.

CROSS-SECTION

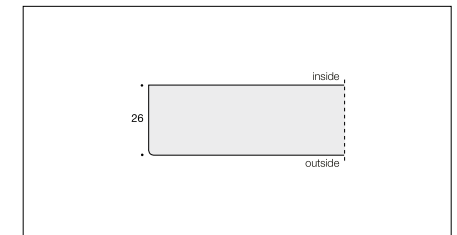

FRONTS

basic color wood

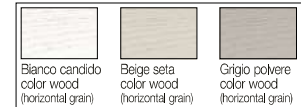

color wood palette finishes



color wood finishes



HANDLES (see page 49 - 50)

	SWING
Avant	•
Chiave Passpartout	•
Filo New L. 1120	•
Gea L. 140 orizzontale	•
Kono Ø 50	•
Lipsi	•
Concealed handle	•
Movida corta L. 260	•
Movida lunga L. 772	•
Push-to-open	o
Petra	•
Sagitta	•
Sky	•
Tecna corta L. 260	•
Tecna lunga L. 772	•

o = NOT AVAILABLE FOR H. 2877, CORNER, END AND OPENING SIDE DOORS

DOOR DIMENSIONS

DOOR TYPES	H. 2256	H. 2384	H. 2544	H. 2896
W. 450	•	•	•	•
W. 500	•	•	•	•
Swing W. 600	•	•	•	•

• = AVAILABLE
 CUSTOM-SIZED REDUCTIONS ON PAGE 277