

PRESENTAZIONE PROGRAMMA ARMADI

ARMADIO BATTENTE

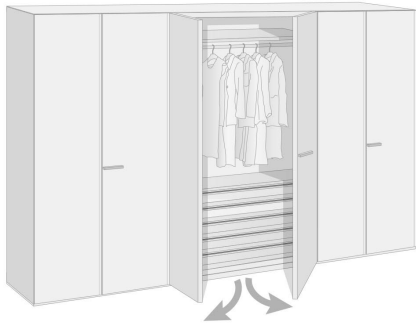

| ALTEZZE: | MODULISTICA: |
|----------|--------------|
| - 2256 | - 425 |
| - 2384 | - 475 |
| - 2544 | - 575 |
| - 2896 | - 875 |
| | - 975 |
| | - 1175 |
| | - Angolo |
| | - Terminale |

PRESENTAZIONE PROGRAMMA ARMADI

ARMADIO COMPLANARE

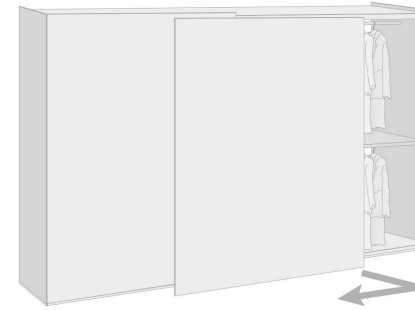

| ALTEZZE: | MODULISTICA: |
|----------|------------------------|
| - 2256 | - 875 _1 anta L. 909 |
| - 2384 | - 975 _1 anta L. 1009 |
| - 2544 | - 1175 _1 anta L. 1209 |
| | - 1325 _1 anta L. 1359 |
| | - 1475 _1 anta L. 1509 |

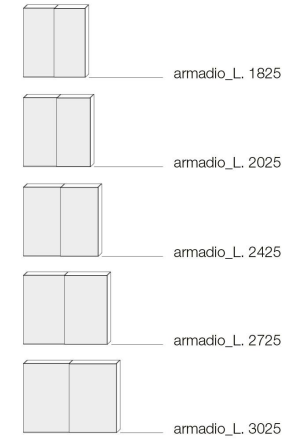

ARMADIO SCORREVOLE

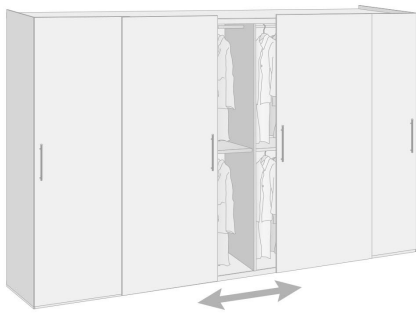

| ALTEZZE: | MODULISTICA: |
|----------|------------------------|
| - 2256 | - 725 _1 anta L. 770 |
| - 2384 | - 875 _1 anta L. 920 |
| - 2544 | - 975 _1 anta L. 1020 |
| | - 1175 _1 anta L. 1220 |
| | - 1325 _1 anta L. 1370 |
| | - 1475 _1 anta L. 1520 |
| | - Angolo |

ANTA ALIBI_BATTENTE

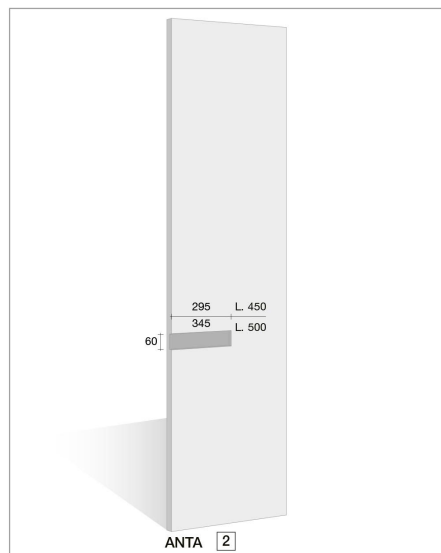
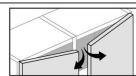

CARATTERISTICHE TECNICHE

L'anta battente Alibi è composta da:
 - un pannello in MDF a basso contenuto di formaldeide spessore 26 mm.
 - un inserto Maniglia spessore 5 mm.

**N.B.: NON DISPONIBILE NEL MODULO TERMINALE
 NON DISPONIBILE CON SERRATURA**

SEZIONE

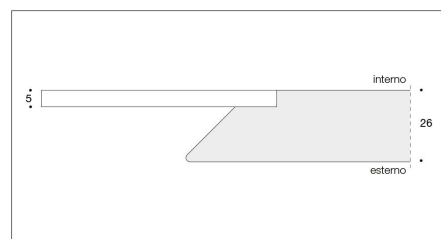

FRONTALI



DIMENSIONI ANTE

| TIPOLOGIA ANTE | H. 2256 | H. 2384 | H. 2544 | H. 2896 |
|-----------------|---------|---------|---------|---------|
| L. 450 | • | • | • | — |
| Battente L. 500 | • | • | • | — |
| L. 600 | — | — | — | — |

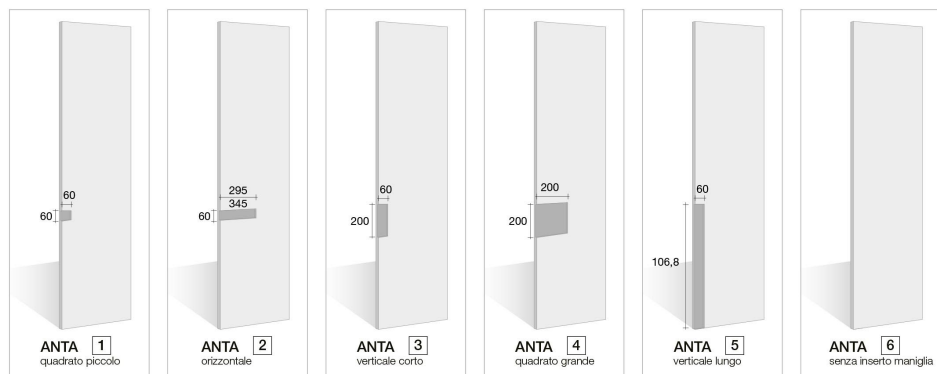

• = DISPONIBILE
 — = NON DISPONIBILE

ANTA ALIBI_BATTENTE

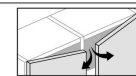

INSERTO MANIGLIA



ESEMPI DI POSSIBILI DISPOSIZIONI DEGLI INSERTI MANIGLIE

